



NOTE: All applicable tap-in fees and permit fees must be paid before a Sewer or Water Permit is issued. Tap-in fees must be paid by cash, check or money order. If sanitary sewer and water service is available, the Owner must apply for a Sewer Permit at the same time applying for a Water Permit on this form.

DATE: _____

SERVICES DESIRED: SANITARY SEWER _____ WATER _____

OWNER’S NAME: _____

OWNER'S PRESENT ADDRESS: _____

CITY: _____ STATE: _____ ZIP CODE: _____

SERVICE ADDRESS: _____ PHONE NUMBER _____

CITY: _____ STATE: _____ ZIP CODE: _____

TYPE OF BUILDING: SINGLE FAMILY RESIDENCE___ MOBLE HOME___ MODULAR___ DUPLEX___

COMMERCIAL___ FACTORY___ RESTAURANT___ WAREHOUSE___ OTHER_____

TYPE OF CONSTRUCTION: SLAB___ CRAWL SPACE___ FULL BASEMENT___ BI LEVEL___

SUBDIVISION (ALLOTMENT): _____ SUBLOT___ ACREAGE___ (IF NOT IN SUBDIVISION)

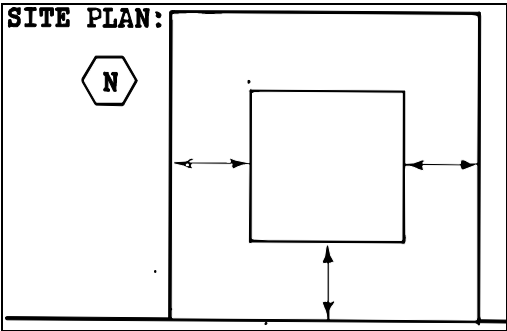

NEW CONSTRUCTION OR EXISTING BUILDING

LOT GRADING: CUT_____ FILL_____

WILL OWNER LIVE AT SERVICE ADDRESS
YES___ NO___ (FOR BILLING PURPOSES)

COMMENTS:

STOP HERE – INFORMATION BELOW PROVIDED BY WATER RESOURCES – STOP HERE

DISTRICT _____ ASSESSMENT NO. _____ SEWER PERMIT NUMBER _____

PROJECT NAME _____ PROJECT NO. _____

PLANT NAME _____ FACILITIES ARE AVAILABLE___ PROJECT IS UNDER CONSTRUCTION ___

USER TYPE: RESIDENTIAL___ RESIDENTIAL MUTI-FAMILY___ MOBILE HOME___

COMMERCIAL___ COMMERCIAL FOOD___

BILLING UNITS: FLAT RATE___ METERED___

JOB LOCATION: TOWNSHIP _____ ORIGINAL LOT NO. ___ PARCEL NO. _____

TAP-IN CHARGE: (BREAKDOWN)

	QUANTITY	AMOUNT
FRONT FOOT		
CONN UNIT		
TRUNK		
PLANT		
PERMIT FEE		
TOTAL		

WYE LOCATION AND DEPTH:

_____ +/- FROM DOWNSTREAM MH

_____ + / -DEEP AT PROPERTY LINE

_____ + / -LENGTH OF LATERAL

COMMENTS: _____

The following information regarding race, national origin and gender is requested to assure the Federal Government, acting through Rural Development, that the County of Portage complying with Federal Laws prohibiting discrimination against applicants.

You are not required to provide this information, but are encouraged to do so. This information will not be used in evaluating your application or to discriminate against you in any way.

RACE

American Indian/Alaskan Native	_____
Asian	_____
Black or African American	_____
Native Hawaiian or Other Pacific Islander	_____
White	_____
Female _____	Male _____

ETHNICITY

Hispanic or Latino	_____
Not Hispanic or Latino	_____
Female _____	Male _____